

**SECTION THRU WINDOW
(TOP VIEW)**

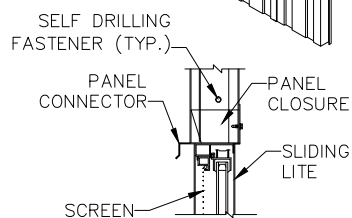

**SECTION THRU WINDOW
(SIDE VIEW)**

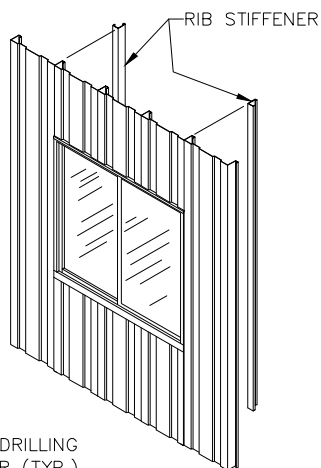
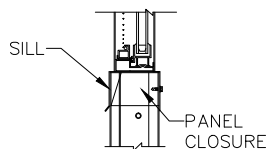

HORIZONTAL SLIDING WINDOWS

PRODUCT DESCRIPTION

SLIDING WINDOW

Sliding windows shall be furnished factory glazed and complete with all attaching hardware and screen. The window unit shall be factory assembled for single unit installation.

All window sash sections shall be of 6063-T5 extruded aluminum and shall be color finished in white or bronze baked enamel. Windows shall meet or exceed AAMA / WDMA / CSA 101/1.S.2 A440-08 specifications. All windows unless otherwise noted, shall be factory glazed with $\frac{5}{8}$ " insulated glass.

Glazing Options: $\frac{1}{4}$ " Acrylic
 $\frac{1}{4}$ " Obscure Glass
 $\frac{1}{4}$ " Polycarbonate Glazing

Available Sizes: 2'-8" wide x 3'-0" high
 4'-0" wide x 3'-0" high
 4'-0" wide x 4'-0" high

Optional: Mullion kits for multiple window installation in building heights up to 12'-0".

PRODUCT NAME

Horizontal Sliding Windows

MANUFACTURER

Parkline, Inc.
 P.O. Box 65
 Winfield, West Virginia 25213
 Phone: (304) 586-2113 in WV
 (800) 786-4855 outside WV
 (304) 586-3842 FAX

web: <http://www.parkline.com>

E-mail: parkline@parkline.com

 **PARKLINE, INC.**
13122HSW